

EASTERN ELECTRICS 2019

KEY

FIRE EXTINGUISHERS

- BLACK DOT - CO2 EXTINGUISHER
- BLUE DOT - POWDER EXTINGUISHER
- RED DOT - WATER EXTINGUISHER

— EMERGENCY VEHICLE ROUTE

☒ MEDICAL

↔ FLOW ARROWS

← Fire exit G1 FIRE EXITS

— LICENSABLE AREA

☐ GENERATORS

▭ MARQUEES

▭ STEELSHIELD

— PED BARRIER

— MOJO BARRIER

— MET BARRIER

— HERAS FENCE

☐ C01/2 C06 CABINS

☐ TOILETS

☐ T2 TRADERS

☐ STAGING

☐ VIEWING PLATFORM

☐ SWIMMING POOL

☐ BIG TOP

☐ STRETCHTENT

☐ BARS

Eastern Electrics 2019 - Licensing Site Plan

MORDEN PARK | 51°23'32.02" 0°12'38.35" | SM4 5QU

Version - v1 | Revision: 1 | Drawn By: Rami Ali - Checked By: Rob D

THE FAIR EASTERN ELECTRICS

EASTERN ELECTRICS 2019

KEY

FIRE EXTINGUISHERS

- BLACK DOT - CO2 EXTINGUISHER
- BLUE DOT - POWDER EXTINGUISHER
- RED DOT - WATER EXTINGUISHER

— EMERGENCY VEHICLE ROUTE

☒ MEDICAL

↔ FLOW ARROWS

← FIRE EXITS G1

— LICENSABLE AREA

☐ GENERATORS

▭ MARQUEES

— STEELSHIELD

— PED BARRIER

— MOJO BARRIER

— MET BARRIER

— HERAS FENCE

CO1/2 CO6 CABINS

☒ TOILETS

T2 TRADERS

☒ STAGING

☒ VIEWING PLATFORM

☒ SWIMMING POOL

☒ BIG TOP

☒ STRETCHTENT

☒ BARS

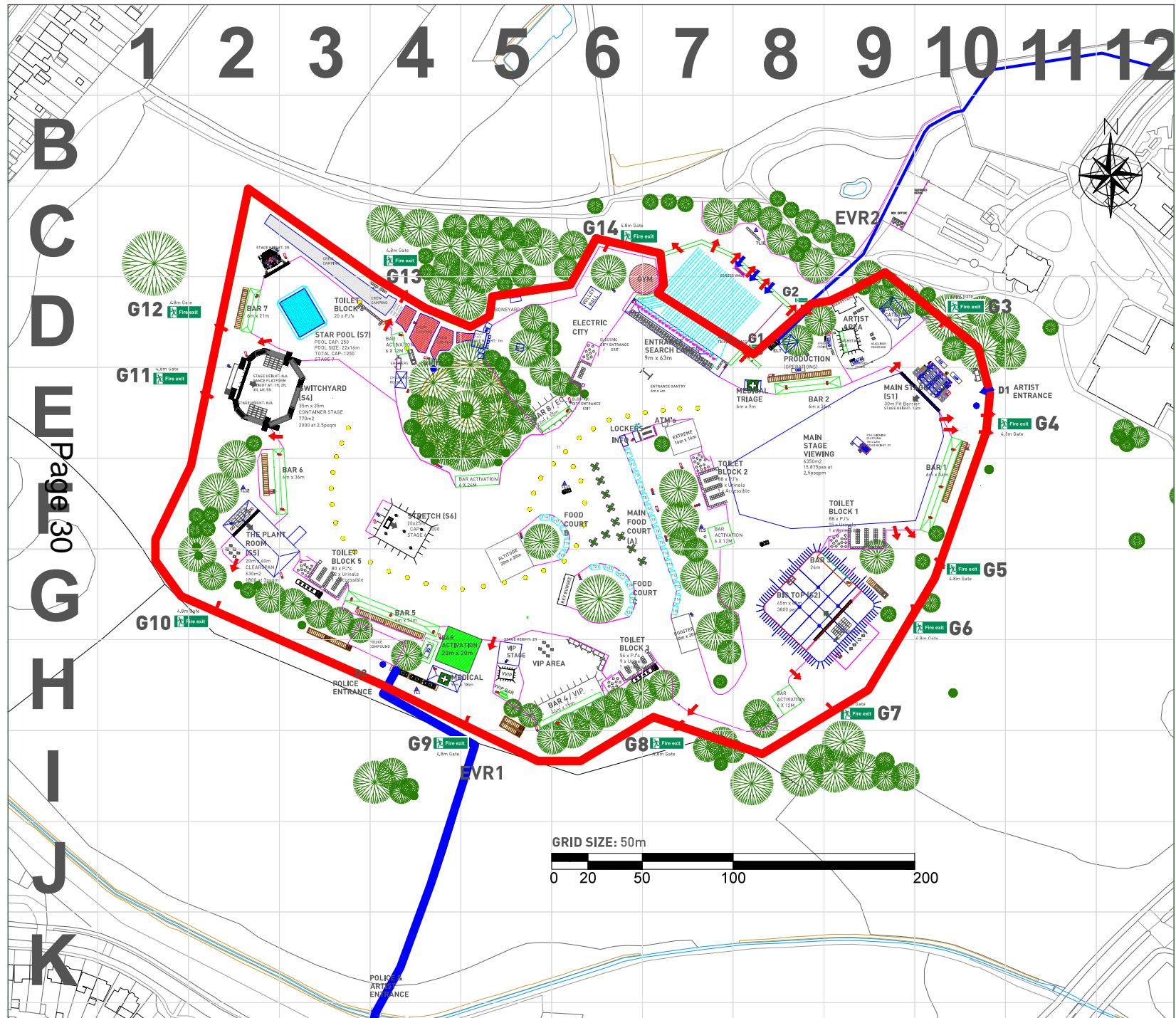

Page 30

Eastern Electrics 2019 - Licensing Site Plan

MORDEN PARK | 51°23'32.02" 0°12'38.35" | SM4 5QU

Version - v1 | Revision: 1 | Drawn By: Rami Ali - Checked By: Rob D



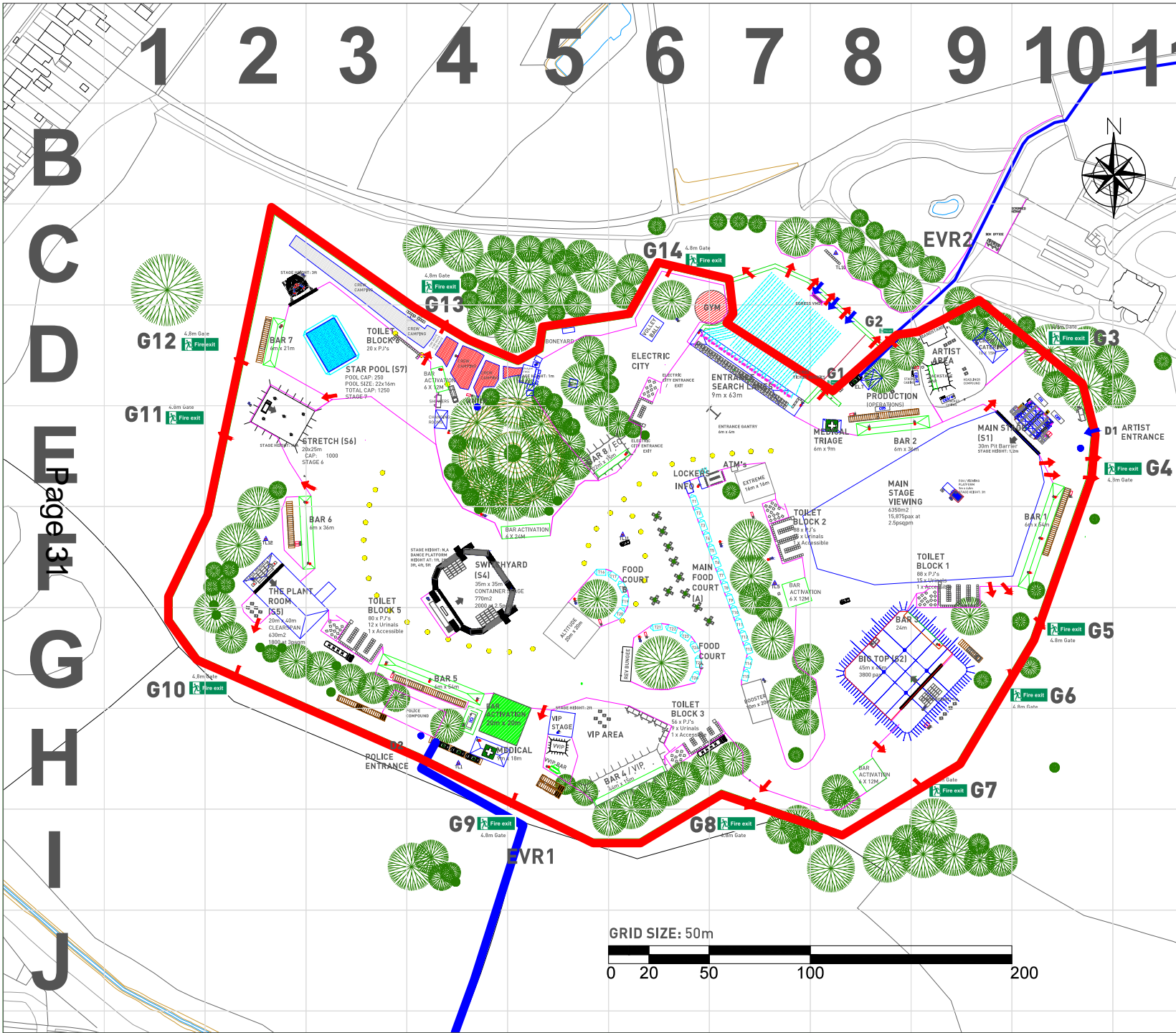

EASTERN ELECTRICS 2019

KEY

FIRE EXTINGUISHERS

- BLACK DOT - CO2 EXTINGUISHER
- BLUE DOT - POWDER EXTINGUISHER
- RED DOT - WATER EXTINGUISHER

— EMERGENCY VEHICLE ROUTE

☒ MEDICAL

↔ FLOW ARROWS

← FIRE EXITS G1

— LICENSABLE AREA

☐ GENERATORS

▭ MARQUEES

▭ STEELSHIELD

— PED BARRIER

▭ MOJO BARRIER

— MET BARRIER

— HERAS FENCE

☐ CABINS C01/2 C06

☐ TOILETS

☐ TRADERS T2

☐ STAGING

☐ VIEWING PLATFORM

☐ SWIMMING POOL

☐ BIG TOP

☐ STRETCH TENT

▭ BARS

Eastern Electrics 2019 - Licensing Site Plan

MORDEN PARK | 51°23'32.02" 0°12'38.35" | SM4 5QU

Version - v1 | Revision: 1 | Drawn By: Rami Ali - Checked By: Rob D

THE FAIR EASTERN ELECTRICS

Page 3 of 11

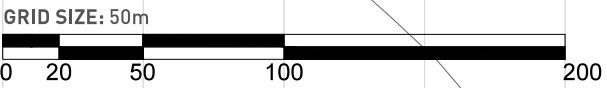

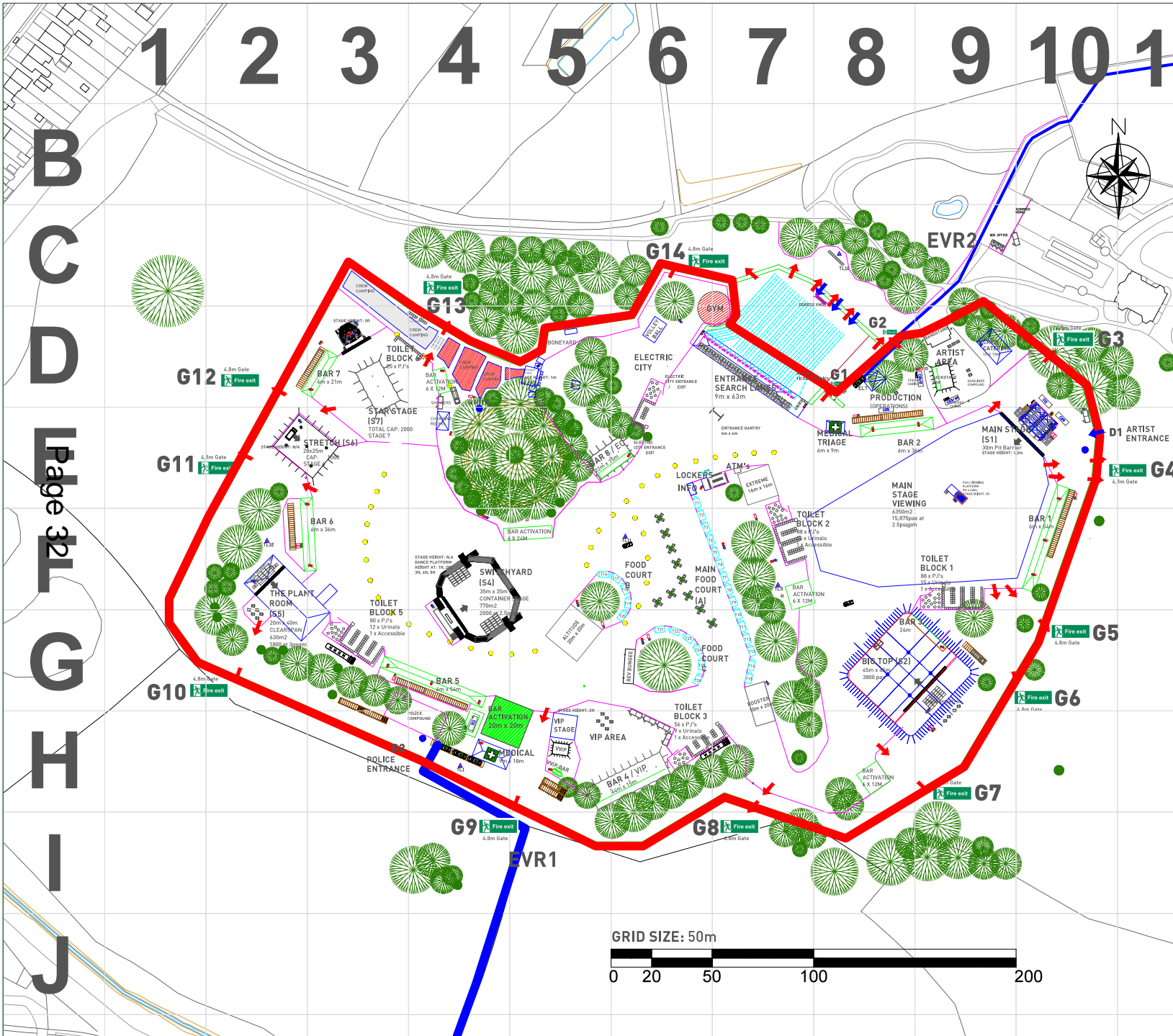

EASTERN ELECTRICS 2019

KEY

FIRE EXTINGUISHERS

- BLACK DOT - CO2 EXTINGUISHER
- BLUE DOT - POWDER EXTINGUISHER
- RED DOT - WATER EXTINGUISHER

— EMERGENCY VEHICLE ROUTE

☒ MEDICAL

↔ FLOW ARROWS

← Fire exit G1 FIRE EXITS

— LICENSABLE AREA

☐ GENERATORS

▭ MARQUEES

▭ STEELSHIELD

— PED BARRIER

— MOJO BARRIER

— MET BARRIER

— HERAS FENCE

☐ C01/2 C06 CABINS

☐ TOILETS

☐ T2 TRADERS

☐ STAGING

☐ VIEWING PLATFORM

☐ SWIMMING POOL

☐ BIG TOP

☐ STRETCHTENT

☐ BARS

Eastern Electrics 2019 - Licensing Site Plan

MORDEN PARK | 51°23'32.02" 0°12'38.35" | SM4 5QU

Version - v1 | Revision: 1 | Drawn By: Rami Ali - Checked By: Rob D

THE FAIR

EASTERN ELECTRICS

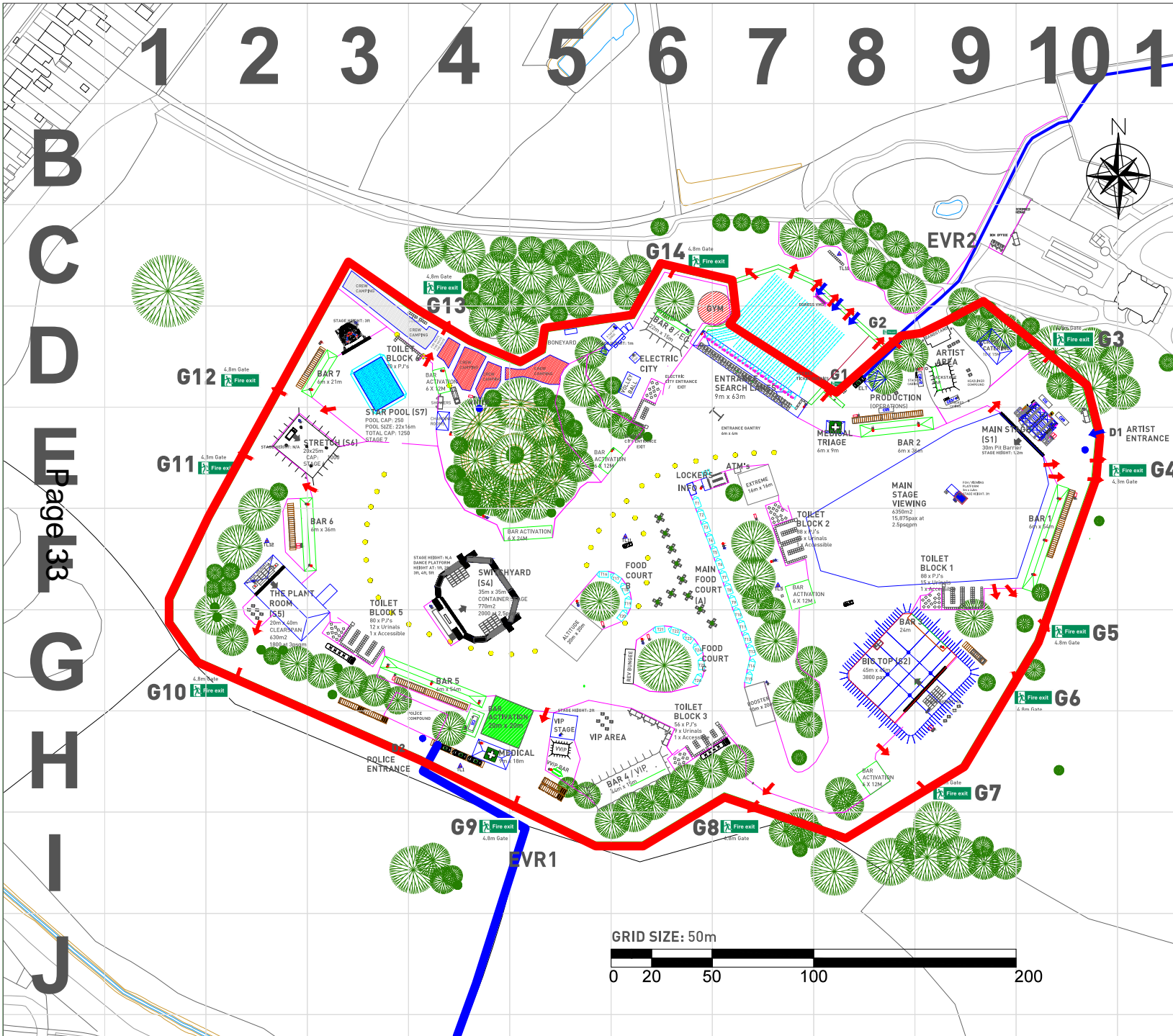

EASTERN ELECTRICS 2019

KEY

FIRE EXTINGUISHERS

- BLACK DOT - CO2 EXTINGUISHER
- BLUE DOT - POWDER EXTINGUISHER
- RED DOT - WATER EXTINGUISHER

— EMERGENCY VEHICLE ROUTE

☒ MEDICAL

↔ FLOW ARROWS

← Fire exit G1 FIRE EXITS

— LICENSABLE AREA

☐ GENERATORS

☐ MARQUEES

— STEELSHIELD

— PED BARRIER

— MOJO BARRIER

— MET BARRIER

— HERAS FENCE

☐ C01/2 C06 CABINS

☐ TOILETS

☐ T2 TRADERS

☐ STAGING

☐ VIEWING PLATFORM

☐ SWIMMING POOL

☐ BIG TOP

☐ STRETCHTENT

☐ BARS

Eastern Electrics 2019 - Licensing Site Plan

MORDEN PARK | 51°23'32.02" 0°12'38.35" | SM4 5QU

Version - v1 | Revision: 1 | Drawn By: Rami Ali - Checked By: Rob D

THE FAIR EASTERN ELECTRICS

This page is intentionally left blank